

**A** BLOCK ELEMENT

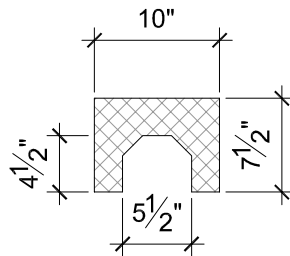

**B** END ELEMENT

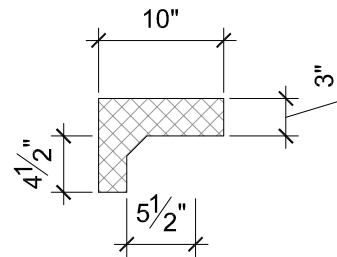

**C** CORNER ELEMENT

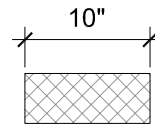

**D** 4" FLAT

- ① ICF BLOCK MUST BE GROUTED SOLID WITH MINIMUM 3000 PSI
- ② PLACING OF CONCRETE INTO THE CORES SHALL COMPLY WITH ACI 318 SECTION 5.10
- ③ REINFORCING  $f_y = 40,000$  PSI FOR #4 BARS AND SMALLER AND  $f_y = 60,000$  PSI FOR #5 BARS AND GREATER
- ④ INSTALLATION OF ICF BLOCK MAY BE ERECTED IN A VERTICAL OR HORIZONTAL POSITION WITH ALL HOLLOWED CELLS ALIGNED
- ⑤ ALL WALLS SHALL BE BRACED ADEQUATELY TO RESIST ALL LOADS DURING THE PLACEMENT OF CONCRETE
- ⑥ ALL CELLS SHALL BE GROUTED SOLID
- ⑦ VERTICAL AND HORIZONTAL SPACING OF REINFORCING BARS SHALL BE 48" O.C. MAXIMUM. REFER TO ENGINEERING PLANS OR CURRENT IRC CODE FOR SPECIAL REINFORCING REQUIREMENTS

## 07 TYPICAL ICF WALL STANDARDS

SCALE: 1'-0" = 3/4"